

# TECHNICAL DATASHEET Accessories

## Reducer profile

BERRY  ALLOC

### Product description

Height adaptable reducer profile for BerryAlloc parquet floor.

Colours 100% matching with BerryAlloc floors.

### Dimensions

L 1150 x w 47 x H 14,2 mm — 1 unit

L 1950 x w 47 x H 14,2 mm — 1 unit

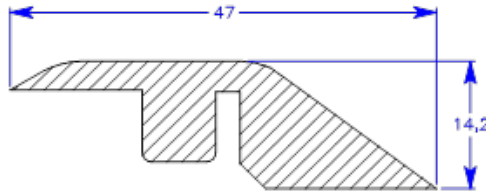

### Installation

Cut the par(s) of the base profile you do not need, depending on floor height :

Total floor + underlay height  
= 11-14 mm

Total floor + underlay height  
= 14-16 mm

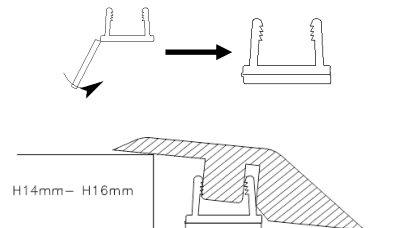
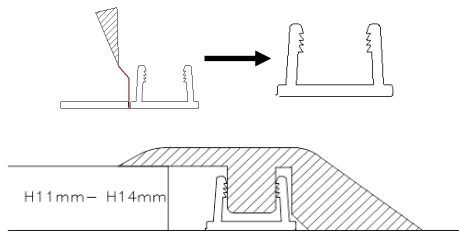

### Product composition

#### Surface

Ultimtec extra mat varnish finish.  
Same colour as the parquet floor.

#### Core

HDF (High Density Fiberboard)

### Certificates

Sustainability of forests : PEFC certified (10-31-1047)

Labelling according to French VOC emission regulation: A+

